

Who May Vote?

All qualified, registered, resident electors are allowed to vote on candidates and Bond Election Questions.

The Town's qualified, registered, non-resident electors are eligible to vote only on the Bond Election Questions. A registered, non-resident municipal elector means any person who is a qualified registered elector of Santa Fe County, Bernalillo County, or Sandoval County but who is a resident of that portion of Santa Fe, Bernalillo, or Sandoval County which is outside of the Edgewood Town limits, has paid property tax on property within the Town of Edgewood, and has registered with the Town Clerk of Edgewood.

The last date for a non-resident elector to complete a certificate of eligibility to vote is 15 days prior to the election or February 15, 2010.

Where Do I Vote?

The polling place, designated by the Town Clerk, is

Edgewood Community Center
27 East Frontage Road
Edgewood, New Mexico 87015

Absentee and early voting will be conducted in the Town Offices located at:
1911 Highway 333, Edgewood, New Mexico.

The deadline for voting absentee in person is
Friday, February 26, 2010 at 5:00 PM.

Applications may be obtained from the Town Clerk's Office.

Dates To Remember

- February 2, 2010: Voter registration begins
- February 10, 2010: Absentee and early voting begins
- February 15, 2010: Last day to file a certificate of eligibility (non-residents)
- February 26, 2010: Last day for absentee and early voting (5:00 PM)
- March 2, 2010: Election Day**

For additional information, please contact:

Karen Mahalick
Town Administrator
(505) 286-4518

DRAFT

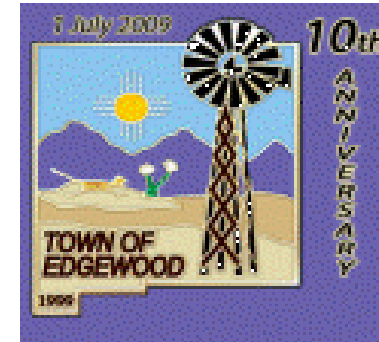

GENERAL OBLIGATION BOND ELECTION

\$2,100,000

General Obligation Street Bonds

&

\$2,100,000

**General Obligation Public Building & Facility
Bonds**

Tuesday, March 2, 2010

7:00 am to 7:00 pm



Prepared under the direction of the
Town of Edgewood Council.

Printed by Town of Edgewood

Ballot Questions

General Obligation Street Bonds Question:

“Shall the Town of Edgewood issue \$2,100,000 of its general obligation bonds to study, design, develop, construct, reconstruct, rehabilitate, renovate, automate, modernize, sign, enhance, landscape and otherwise improve, and to acquire land and equipment for municipal streets and roads?”

General Obligation Public Building and Facility Bonds Question:

“Shall the Town of Edgewood issue \$2,100,000 of its general obligation bonds to design, develop, study, construct, modernize, automate, renovate, rehabilitate, recondition, landscape, furnish, equip, enhance and and otherwise improve, and to acquire land and buildings, apparatus, and equipment for town buildings and facilities, including facilities for the Public Works Department, Municipal Administration, and Library?”

The Cost

APPROVAL OF BOTH G/O BOND QUESTIONS WILL IMPACT PROPERTY OWNERS AS FOLLOWS:

TAX RATE INCREASE OF: \$ 2.630 \$ 2.630

Full Value	Assessed Value	Streets & Roads		Public Bldg. & Facility	
		Increase Per Year	Increase Per Month	Increase Per Year	Increase Per Month
\$100,000	\$26,333	\$69.26	\$5.77	\$69.26	\$5.77
150,000	40,500	106.52	8.88	106.52	8.88
200,000	54,667	143.77	11.98	143.77	11.98
250,000	68,833	181.03	15.09	181.03	15.09
350,000	97,167	255.55	21.30	255.55	21.30
500,000	139,667	367.32	30.61	367.32	30.61

Assessed value computed as follows:
85% of full value divided by 3, less \$2,000 for head of household deduction

Current & Proposed Property Tax Rates for the Town of Edgewood

	Santa Fe County		Bernalillo County		Sandoval County	
	Current	Proposed	Current	Proposed	Current	Proposed
State Debt Service	\$1.150	\$1.150	\$1.150	\$1.150	\$1.150	\$1.150
County Debt Service	1.930	1.930	0.994	0.994	0.673	0.673
Municipal Debt Service (Streets & Roads)	-	2.630	-	2.630	-	2.630
Municipal Debt Service (Public Building & Facility)	-	2.630	-	2.630	-	2.630
UNM Hospital	-	-	6.400	6.400	4.250	4.250
School District Debt Service	10.964	10.964	10.964	10.964	11.464	11.464
Total Tax Rate	\$14.044	\$19.304	\$19.508	\$24.768	\$17.537	\$22.797
% Increase for Street Bonds		18.7%		13.5%		15.0%
% Increase for Public Building & Facility Bonds		18.7%		13.5%		15.0%

This Tax Measure. . . .

- ✓ Represents a significant investment in the Town of Edgewood
- ✓ Will provide funds for Public Works Facility ¾ of a mile east of Highway 344 on Venus Road
- ✓ Will provide funds for Municipal Facilities in the Town Center on Section 16

Development Projects for Edgewood

Public Works Building on Venus Road

- ✓ Advertise for public works building
- ✓ Construct infrastructure
- ✓ Construct public works building

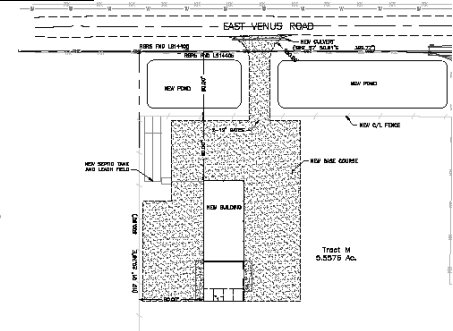

Municipal Administration / Library on Section 16

- ✓ Advertise for architectural services
- ✓ Construct infrastructure
- ✓ Construct Municipal Administration & Library

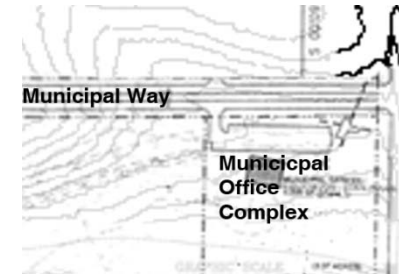

Municipal Paving Program

- ✓ Establish a schedule for paving municipal streets
- ✓ Improves response time for emergency responders
- ✓ Helps to improve property values

